

# PRICELIST & SPECIFICATION

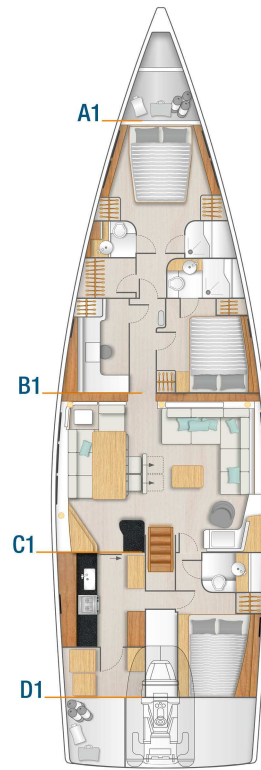

LOA		21.10 m	69' 3"
Hull length		20.50 m	67' 3"
LWL		19.20 m	63' 0"
Beam		5.90 m	19' 4"
Draft			
shallow keel		2.70 m	8' 10"
L-keel, medium		3.10 m	10' 2"
Displacement			
shallow keel	approx.	37.80 t	83,335 lbs
L-keel, medium	approx.	37.10 t	81,791 lbs
Engine Diesel			
standard	approx.	150 PS	150 hp
option	approx.	230 PS	230 hp
Fuel tank	approx.	1.100 l	291 gal
Fresh water	approx.	900 l	238 gal
CE Certificate	A - 12		
Design	judel / vroljik & co		
Interior	HanseYachts Design		
Mast length above WL	approx.	31.95 m	104' 10"
Total sail area	approx.	244.50 m <sup>2</sup>	2,632 sq ft
Main sail			
standard	approx.	145.50 m <sup>2</sup>	1,566 sq ft
furling	approx.	132.00 m <sup>2</sup>	1,421 sq ft
Self-tacking jib	approx.	99.00 m <sup>2</sup>	1,066 sq ft
Reacher	approx.	168.00 m <sup>2</sup>	1,808 sq ft
Gennaker	approx.	370.00 m <sup>2</sup>	3,983 sq ft

# 675

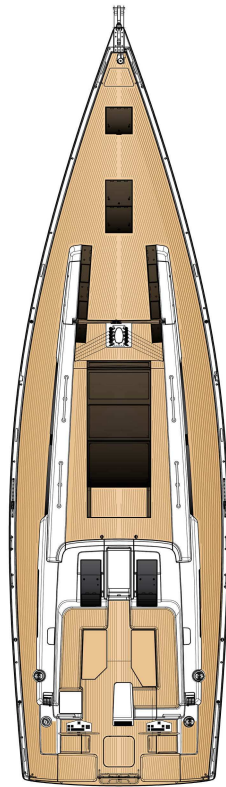

Standard

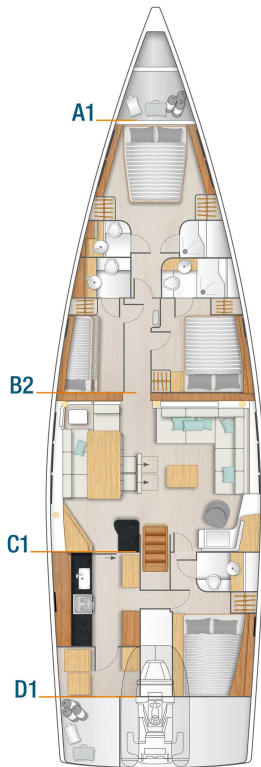

Option

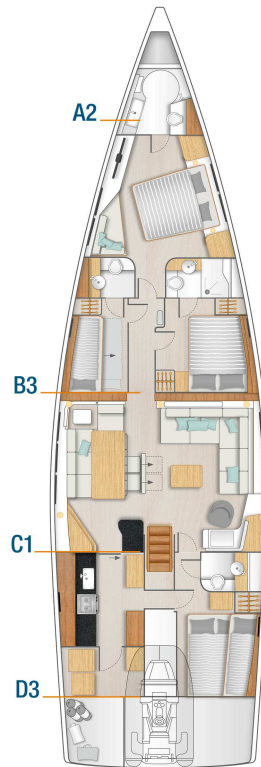

Option

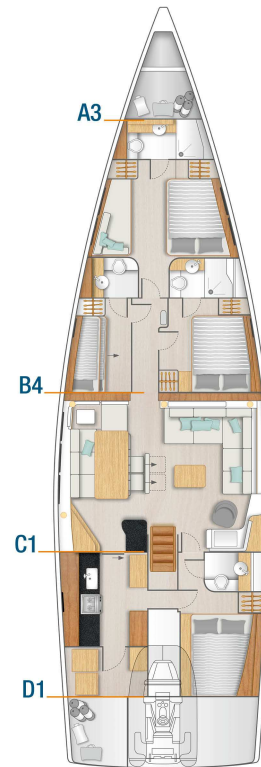

Option

**HULL**

- 14 hull windows (7 each side)
- GRP hull, isophthalic gelcoat, colour: Signal White (RAL9003), 1st layer vinyl ester resin and balsa sandwich laminat
- Waterline and cove line, isophthalic gelcoat, colour: Dark Grey (RAL 7043)

**KEEL**

- L-keel, cast iron, draft: 3.10 m

**LAYOUT & INTERIOR**

- A1: Sail locker in bow and master cabin with island berth, storage space and a separate head on port and shower stall on stb
- B1: VIP cabin with double berth, storage space and separate head with shower stall on stb and office and walk-in locker on port
- C1: Saloon with lounge area with L-sofa and large navigation area on stb and bar and dinning table on port
- D1: Full functional galley with utility room on port and double cabin with separate head on stb
- 3-burner gas stove with oven, ventilation hood, waste bin, 12 V fridge approx. 140 l, double stainless steel sink with mixing tab
- Interior furniture in high quality marine plywood, satin varnished
- Hanse companionway closing system
- Saloon table, fixed
- Worktop in galley - Corian Anthracite
- Courtesy lights in saloon
- Indirect lights in saloon and cabins, dimmable
- LED overhead lights in saloon and cabins, dimmable

**WOOD (FURNITURE, FLOORBOARD)**

- Furniture - Mahogany Style , Satin Varnish
- Cupboards fronts in wood colour
- Floorboard - Acacia
- Floorboard - wooden grating in all heads and showers

**UPHOLSTERY**

- Comfort mattresses for all berths
- Upholstery - Monte Carlo, colour: Cream

**DECK & OUTSIDE EQUIPMENT**

- GRP deck with antislip surface, isophthalic gelcoat, colour: Signal White (RAL 9003), 1st layer vinyl ester resin and balsa sandwich core. Cockpit locker on port and stb, stern locker, dinghy garage, stowage for running rigging at helm position, anchor locker at bow.
- Teak on cockpit bottom
- Teak on bathing platform
- 2 stainless steel steering wheels with leather cover
- 2 cockpit tables, stainless steel frame with teak top
- Pulpit and pushpit, stainless steel
- Railing, incl. stanchions and stainless steel wire with gateway stanchion
- Covered halyards and control lines lead to cockpit helmposition, organizers and jammers, 8 retractable mooring cleats, handrail on coachroof, bow anchor fitting with step
- 2 LEWMAR 65 EST EVO electrical halyard winches with automatic fuse
- 2 LEWMAR 65 ST EVO manual secondary winches
- Bathing platform, hydraulic fold-out, remote control and swimming ladder
- Courtesy lights in cockpit
- Helmsman footrests (extractable)
- Anchor windlass, electrical, 2000 W, with automatic fuse and remote control with chain counter
- Delta-anchor 45 kg, galvanized with 60 m galvanized chain
- Genoa tracks incl. cars with pin stop
- Self tacking jib system
- Mainsheet system
- 7 big and 6 small deck hatches - openable, anchor locker hatch, stowage on coachroof with acrylic glass hatch
- 10 deck coach roof windows - 4 openable on side, 1 openable as sliding roof, portlights in cockpit sides for aft cabins

**RIG & SAILS**

- Rig, anodized aluminium, keel stepped, with kicker, standing and running rigging and 2 reefs
- Backstay tensioner, hydraulic
- Vang, hydraulic
- Hydraulic jib furler

## PROPULSION

- Fuel tank, approx. 1100 l
- Engine (Diesel, approx. 150 hp) - shaft drive, 4-blade folding propeller
- Bowthruster, 24V, 145 kp, retractable incl. batteries, electric

## EQUIPMENT

- 24 V and 230 V electric system with digital switchboards, bus system, 230 V shore power and sockets in cabins and heads
- AGM battery set, capacity: 1x 90 Ah + 4x 225 Ah (450 Ah at 24 V)
- Inverter/charger, 24 V / 7000 W - 200 A
- Manual toilet with sea water flush - cabin layout D1 and D3
- Electric toilet with sea water flush - cabin layout A1 - A3
- Manual toilet with sea water flush - cabin layout B1
- Manual toilet with sea water flush - cabin layout B2 - B4
- Shower unit in cockpit, warm-/ coldwater
- LPG gas system, 2 bottles in stowage
- Blackwater system (appr. 185 l, appr. 85 l for aft head) with deck extraction and seacock for head, electric and manual bilge pump
- Freshwater system with electric pump and 75 l hotwater, heated also by main engine
- Fresh water tank, appr. 900 l

## ACCESSORIES

- Blind set with flyscreens for hatches, portlights and deck windows
- Blinds for hull windows in saloon and master cabin
- Blind for sunroof in saloon, electric
- Blinds for side coach roof windows
- LED Navigation lights, bow & stern
- Wind indicator
- Flagpole
- 8 fenders
- 8 mooring lines
- HANSE maintenance kit

## SHIPPING & TRANSPORT

- CE - Certificate cat. A - 12
- Owners manual
- EC - Type Examination Certificate

AS PER STANDARD SPECIFICATION

\$ 1,465,000

## PACKAGES

<b>XW2010</b>	<b>B&amp;G Navigation Package (only with XK5000 or XK5010 for TV)</b>	<b>\$ 43,357</b>
XF2201	2 B&G H5000 multifunction displays on helmconsole, incl. transducer (wind/speed/depth/temperature)	
XF2223	2 B&G H5000 add. multifunction displays in cockpit	
XF3000	B&G VHF V90S at chart table, incl. wireless remote handset H50 (only with XK5000 or XK5010)	
XF4000	B&G Zeus <sup>3</sup> Touch 16" Glass Helm chart plotter at chart table	
XF4011	B&G Zeus <sup>3</sup> Touch 19" Glass Helm chart plotter in cockpit	
XF4550	Hanse safety cloud with 24 months subscription and device installed on board	
XF4600	B&G AIS Class B transponder	
XF5001	B&G Autopilot with 2 H5000 control units and Precision 9 compass	
XF5200	B&G CPU Hydra computer	
XF9001	NMEA engine information interface for chart plotter	
XF9100	GoFree wireless link	
<hr/>		
<b>XW2011</b>	<b>Upgrade - 2 B&amp;G 12" chart plotter at helm station, instead of B&amp;G 19" chart plotter in cockpit</b>	<b>\$ 1,373</b>
XF4031	2 B&G Zeus <sup>3</sup> 12" chart plotter, 1 per helm station	
<hr/>		
<b>XW7000</b>	<b>Entertainment Package - Saloon and cockpit (only with XK5000 or XK5010 for TV)</b>	<b>\$ 4,323</b>
XH2090	Wireless charging	
XK1000	FUSION MS-AV755 Multimedia radio with bluetooth and CD/DVD player - for saloon and cockpit	
XK2040	4 high-end 2-way speakers in saloon	
XK2070	2 high-end 2-way speakers in cockpit	
XK3070	FUSION MS-NRX remote control in cockpit	
XK5030	FUSION wireless link - remote control via mobile devices	
<hr/>		
<b>XW7010</b>	<b>Entertainment Package - Master cabin (only with XK5000 or XK5010 for TV)</b>	<b>\$ 4,193</b>
XK1010	FUSION MS-AV755 Multimedia radio with bluetooth and CD/DVD player - master cabin	
XK2010	2 high-end 2-way speakers in master cabin	

<b>XW7016</b>	<b>TV Preparation Package - Master cabin (only with XW7035 or XK5010)</b>	<b>\$ 4,034</b>
XK1310	Blu-ray player in master cabin	
XK4071	TV preparation in master cabin - US version	
XK4310	APPLE TV in master cabin	

<b>XW7035</b>	<b>TV Preparation Package - Saloon (only with XK5010)</b>	<b>\$ 5,768</b>
XK1340	Blu-ray player in saloon	
XK4070	TV preparation in saloon - US version	
XK4340	APPLE TV in saloon	

## OPTIONS

### HULL

XA1001	GRP hull, gelcoat colour: Grey (RAL 7040)	<b>\$ 12,867</b>
XA1002	GRP hull, painted, non-metallic (colour selection)	<b>\$ 50,455</b>
XA1003	GRP hull, painted, metallic (colour selection)	<b>\$ 64,913</b>
XA3001	Waterline and cove line, coloured gelcoat (colour selection - not with XA1002 or XA1003)	<b>\$ 1,287</b>
XA3002	Waterline and cove line, painted, non metallic (colour selection - only with XA1002 or XA1003)	<b>\$ 1,287</b>
XA3003	Waterline and cove line, painted, metallic (colour selection - only with XA1002 or XA1003)	<b>\$ 4,482</b>

### KEEL

XB1001	L-keel, cast iron/lead, draft: 2.70 m	<b>\$ 46,118</b>
--------	---------------------------------------	------------------

### LAYOUT & INTERIOR

XL1002	A2: Master cabin with transversal island berth, storage space and generous head with separate shower stall in bow	<b>\$ 12,867</b>
XL1003	A3: Sail locker in bow and master cabin with double berth on stb, sofa on port and a separate head with shower stall	<b>\$ 9,975</b>
XL2002	B2: VIP cabin with double berth, storage space and separate head with shower stall on stb and cabin with double bunk bed and separate head on port	<b>\$ 9,455</b>
XL2003	B3: VIP cabin with double berth, storage space and separate head with shower stall on stb and cabin with retractable double berth and separate head on port	<b>\$ 12,144</b>
XL2004	B4: VIP cabin with double berth, storage space and separate head with shower stall on stb and cabin with bunk bed, retractable double berth and separate head on port	<b>\$ 12,867</b>

XL4003	D3: Full functional galley with utility room on port and cabin with bunk bed, double berth and retractable table and separate head on stb	<b>\$ 8,371</b>
XL7001	Saloon table electrically lowerable with cushions, convertible into double berth	<b>\$ 6,506</b>
XL7601	Worktop in galley - Corian Vanilla	<b>\$ 1,287</b>
XL9030	Acrylic insert with indirect lights in saloon	<b>\$ 4,193</b>

## WOOD (FURNITURE, FLOORBOARD)

XM1102	Furniture - Canadian Chestnut	<b>\$ 12,997</b>
XM1103	Furniture - Teak, satin varnish	<b>\$ 14,443</b>
XM1104	Furniture - French Oak	<b>\$ 12,997</b>
XM1150	Furniture - High gloss finish (only with XM1100 or XM1102)	<b>\$ 27,324</b>
XM1161	Cupboard fronts coloured (partial as per design - colour selection)	<b>\$ 7,084</b>
XM1202	Floorboard - Noce Nero	<b>\$ 1,865</b>
XM1203	Floorboard - Delight Oak	<b>\$ 1,865</b>

## UPHOLSTERY

XN1100	Deluxe mattresses for all berths	<b>\$ 4,988</b>
XN2001	Upholstery - Sorrento (colour selection)	<b>\$ 4,048</b>
XN2002	Upholstery - Florence (colour selection)	<b>\$ 5,638</b>
XN2003	Upholstery - Monaco (colour selection)	<b>\$ 8,082</b>
XN2004	Upholstery - Portofino Leather (colour selection)	<b>\$ 12,274</b>
XN2080	2 foldable directors chairs for saloon or cockpit	<b>\$ 2,819</b>
XN2200	Sun bed cushion on foredeck (colour selection)	<b>\$ 3,976</b>
XN2201	Comfort sun bed cushions on foredeck (colour selection)	<b>\$ 7,735</b>
XN2500	Cockpit cushions (colour selection)	<b>\$ 4,699</b>
XN2501	Comfort cockpit cushions (colour selection)	<b>\$ 9,036</b>
XN3014	Carpets in cabins and passage to forward cabins (colour selection)	<b>\$ 4,308</b>
XN3020	Paillason in saloon (colour selection)	<b>\$ 3,831</b>

## DECK & OUTSIDE EQUIPMENT

XC1300	Teak on side deck	<b>\$ 36,128</b>
XC1301	Synthetic teak on side deck (colour selection)	<b>\$ 41,911</b>
XC1310	Teak on coach roof	<b>\$ 18,650</b>
XC1311	Synthetic teak on coach roof (colour selection)	<b>\$ 20,095</b>
XC1321	Synthetic teak on cockpit bottom (colour selection)	<b>\$ 5,768</b>

XC1333	Teak on helmsman seats	<b>\$ 708</b>
XC1334	Synthetic teak on helmsman seats (colour selection)	<b>\$ 853</b>
XC1351	Synthetic teak on bathing platform (colour selection)	<b>\$ 853</b>
XC2201	2 GRP steering wheels, Y-spoke (black or white)	<b>\$ 2,299</b>
XC2202	2 GRP steering wheels, Y-spoke, carbon clear coated	<b>\$ 7,807</b>
XC3004	2 cockpit tables, stainless steel with teak tops and handrail, electrically lowerable into sunbed incl. upholstery	<b>\$ 7,084</b>
XC5105	2 LEWMAR 80 EST EVO electrical halyard winches with automatic fuse (only with XH1001 or XH1005)	<b>\$ 29,623</b>
XC5202	2 LEWMAR 65 EST EVO electrical secondary winches with automatic fuse (only with XH1001 or XH1005)	<b>\$ 11,551</b>
XC5205	2 LEWMAR 80 EST EVO electrical secondary winches with automatic fuse (only with XH1001 or XH1005)	<b>\$ 29,623</b>
XC6501	Gangway, carbon, foldable with bag, 220 cm	<b>\$ 4,034</b>
XC6502	Gangway, retractable, electric/hydraulic with remote control	<b>\$ 31,661</b>
XC6601	Stainless steel ladder for gateway exit, foldable	<b>\$ 1,431</b>
XC7001	Easy Tender System with windlass and launching system	<b>\$ 14,313</b>
XC7100	Air compressor for tender	<b>\$ 983</b>
XC9020	Rub rail, teak	<b>\$ 7,084</b>
XC9021	Additional stainless steel rail (only with XC9020)	<b>\$ 4,193</b>
XC9040	LED lights for side decks, integrated in toerail, white	<b>\$ 5,277</b>
XC9041	6 underwater lights below transom	<b>\$ 5,046</b>
XC9051	Electrical deck wash pump, mounted in bow area with outlet on deck	<b>\$ 1,431</b>
XC9060	2 helmsman seats, foldable on stb (only with XC1333 or XC1334)	<b>\$ 2,819</b>
XC9081	4 enlarged cleats - bow and stern and 4 standard size cleats - midship (2 each side)	<b>\$ 11,537</b>
XC9088	Combined mooring/anchor windlass, 2000W, electrical, with automatic fuse, incl. chain counter and remote control (only with XH1001 or XH1005)	<b>\$ 3,744</b>
XC9089	Combined mooring/anchor windlass, 3000W, electrical, with automatic fuse, incl. chain counter and remote control (only with XH1001 or XH1005)	<b>\$ 5,768</b>
XC9101	Ultra-anchor 45 kg, stainless steel, with Ultra Flip swivel and 100 m stainless steel chain, dia. 13 mm	<b>\$ 9,903</b>

## RIG & SAILS

XE1001	Rig, anodized aluminium with hydraulic inmast furling system	<b>\$ 38,022</b>
XE1002	Rig, carbon, painted (only with XE9002)	<b>\$ 173,124</b>
XE1004	Rig, anodized aluminium, painted (only with XE9002)	<b>\$ 26,746</b>
XE1065	Furling boom, carbon, electric (only with XE1000 and XE1111)	<b>\$ 119,705</b>
XE1071	Park Avenue boom, carbon, painted (colour selection - only with XE1002 - not with XE1001)	<b>\$ 50,455</b>
XE1111	RECKMANN Furl finder - automatically adjusting vang (only for XE1065 or XE1066)	<b>\$ 37,227</b>
XE1221	Second forestay with second furler, hydraulic	<b>\$ 24,433</b>



XE2001	Lazy bag with lazy jacks (colour selection - not with XE1001, XE1065, XE1066, XE1070, XE1071)	<b>\$ 3,325</b>
XE2009	Canvas windscreen with stainless steel stake (colour selection - not with XE2010)	<b>\$ 5,494</b>
XE2010	Fixed windscreen with stainless steel frame (not with XE2012)	<b>\$ 10,091</b>
XE2012	Sprayhood with stainless steel stake, 3 windows (1 openable - colour selection - not with XE2009, XE2010, XE2051, XE2052 and XE2053)	<b>\$ 5,421</b>
XE2013	Cockpit canvas cover for GRP hardtop - side and front (colour selection - only with XE2051/XE2052/XE2053 and XE2009 or XE2010)	<b>\$ 5,711</b>
XE2021	Bimini top with stainless steel stake (colour selection - not with XE2049, XE2051, XE2052 or XE2053)	<b>\$ 11,421</b>
XE2049	GRP arch for cockpit - white	<b>\$ 14,457</b>
XE2051	GRP hard top for cockpit with canvas sliding roof - white	<b>\$ 35,998</b>
XE2052	GRP hard top for cockpit with canvas sliding roof - outside surface painted, non metallic (colour selection)	<b>\$ 43,227</b>
XE2053	GRP hard top for cockpit with canvas sliding roof - outside surface painted, metallic (colour selection)	<b>\$ 47,564</b>
XE3010	ELVSTRÖM HPM high - performance sails, full battened, UV protected membrane, main and jib	<b>\$ 86,598</b>
XE3024	ELVSTRÖM HPM high - performance sail - for second forestay, UV - protected membrane, Reacher 140% (only with XE1221)	<b>\$ 50,586</b>
XE3105	QUANTUM Gennaker (colour selection)	<b>\$ 17,204</b>
XE3110	Squeezer for gennaker	<b>\$ 3,253</b>
XE9002	HARKEN Y-track for main sail (not with XE1001, XE1065, XE1066)	<b>\$ 18,577</b>
XE9003	Gennaker package incl. halyard, 2 sheets, 2 blocks and 2 padeyes	<b>\$ 4,482</b>
XE9100	Spreader lights, LED, 6 up and 6 down	<b>\$ 5,566</b>

## NAVIGATION & INSTRUMENTS

XF4500	B&G 4G Broadband Radar (only with XW2010)	<b>\$ 4,323</b>
XF4701	B&G forward looking sonar (only with XW2010)	<b>\$ 2,096</b>
XF5150	B&G WR10 autopilot remote controller, wireless (only with XW2010 and XF5001)	<b>\$ 795</b>
XF9001	NMEA engine information interface for chart plotter	<b>\$ 983</b>

## PROPULSION

XG1105	Engine (Diesel, approx. 230 hp) - shaft drive, 4-blade folding propeller	<b>\$ 25,878</b>
XG3201	Sternthruuster, 24V, 145 kp, retractable incl. batteries, electric	<b>\$ 21,541</b>
XG3211	Add. electronic throttle at helm position on port	<b>\$ 4,120</b>

## EQUIPMENT

XH1001	Battery set, capacity: 1x 90 Ah + 8x 225 Ah (900 Ah at 24 V)	<b>\$ 5,624</b>
XH1005	Battery set, capacity: 1x 90 Ah + 4x 180 Ah Li-lo (720 Ah at 24 V)	<b>\$ 34,148</b>

XH2101	Generator 15000i, 12,0 kW / 15,0kVA, incl. maintenance kit	<b>\$ 35,998</b>
XH2151	2nd shore power connection with charger, 100 A (only with XH1001 or XH1005)	<b>\$ 7,518</b>
XH3001	Electric toilet with sea water flush - cabin layout D1 and D3	<b>\$ 2,385</b>
XH3021	Electric toilet with sea water flush - cabin layout B1	<b>\$ 2,154</b>
XH3031	Electric toilet with sea water flush - cabin layout B2 - B4	<b>\$ 4,308</b>
XH3200	Freshwater dockside connection in cockpit	<b>\$ 651</b>
XH4100	Heating, hot water ring with blowers in each cabin and head	<b>\$ 21,541</b>
XH4511	Air conditioning, 60.000 BTU, 7 units: 2 saloon, fwd cabin, 2 guest cabin, pantry, aft cabin, incl. 2nd shore power	<b>\$ 57,684</b>
XH4512	Air conditioning, 72.000 BTU, 7 units: 2 saloon, fwd cabin, 2 guest cabin, pantry, aft cabin, incl. 2nd shore power	<b>\$ 64,913</b>
XH5020	Water maker, 230 V, 200 l / h (only with XH2101)	<b>\$ 31,661</b>
XH5101	Additional fridge in cockpit wetbar	<b>\$ 2,675</b>
XH5110	Additional fridge in saloon (only with XH1001 or XH1005)	<b>\$ 2,602</b>
XH5111	Additional freezer in galley (only with XH1001 or XH1005)	<b>\$ 2,747</b>
XH5112	Wine cooler in saloon	<b>\$ 3,181</b>
XH5120	Additional freezer in utility room (only with XH1001 or XH1005)	<b>\$ 2,747</b>
XH5130	Ice maker in saloon	<b>\$ 2,877</b>
XH5140	BBQ in wetbar	<b>\$ 2,096</b>
XH5155	Microwave preparation - US version	<b>\$ 1,287</b>
XH5160	Coffeemachine in saloon	<b>\$ 998</b>
XH5161	BOSCH coffeemachine in saloon	<b>\$ 3,542</b>
XH5210	Dishwasher in galley (only with XH2101)	<b>\$ 3,600</b>
XH5320	Washing machine with dryer function - preparation US version	<b>\$ 2,154</b>
XH5409	Gas leak detector	<b>\$ 1,070</b>
XH5412	Steam cooker in galley	<b>\$ 3,542</b>
XH6001	Grey-water system for bathrooms and galley, 2 tanks: 370 l	<b>\$ 7,229</b>

## RADIO & ENTERTAINMENT

XK5000	VHF preparation with antenna and splitter for FM and AIS	<b>\$ 419</b>
XK5010	All-In-One antenna at mast top (VHF, FM radio, TV- analog and DVBT)	<b>\$ 2,747</b>
XK5011	Antenna for 3/4G internet and wi-fi onboard	<b>\$ 1,706</b>

## ACCESSORIES

XV9090	Ventian blinds for hull windows in saloon and master cabin (colour selection)	<b>\$ 6,000</b>
XV9120	Cockpit table cover (colour selection)	<b>\$ 998</b>
XV9130	Covers for steering wheels (colour selection)	<b>\$ 564</b>

XV9380	Shrink wrap foil (for storage purpose only / not for transport) (not with XA1002, XA1003, XE2051, XE2052, XE2053)	<b>\$ 4,048</b>
--------	---	-----------------

---

## SHIPPING & TRANSPORT

XZ3001	Rigging and delivery in Greifswald	<b>\$ 27,324</b>
--------	------------------------------------	------------------

All mentioned prices in US-Dollars. Delivery ex works shipyard Greifswald/Germany (no freight or duty included). Prices are subject to change without notice. All weights and measures are calculated numbers based on the construction data. Changes in construction and equipment reserved. Boat according to US specifications. Company reserves additional 15 working days when painted hull is ordered. All measurements/figures are approximate. Errors and omissions excepted. Specification and material can be changed without notice. Valid from 2020.01.01.